

1 501 DOR 1 1 1 892

741 Filed This 9 day of July 1968
And Recorded in Vol. 44 Page 49 at 4:38 P.M.
Ollie L. Amosworth
Register Marine Commission Greenville County, S. C.

GIBSON HEIGHTS

PROPERTY OF

MARY E. BRIGHT

LOCATED NEAR WASHINGTON BAPTIST CHURCH

ONEAL TOWNSHIP GREENVILLE COUNTY

SOUTH CAROLINA

SCALE: 1" = 100 FEET JAN. 13, 1965

SURVEYED JAN. 1965

FILED
GREENVILLE CO. S. C.
JUL 9 4 38 PM 1968
OLLIE L. AMOSWORTH
R.M.C.

H.S. BROCKMAN REG. SURVEYOR
GREENVILLE, S. C. NO. 959

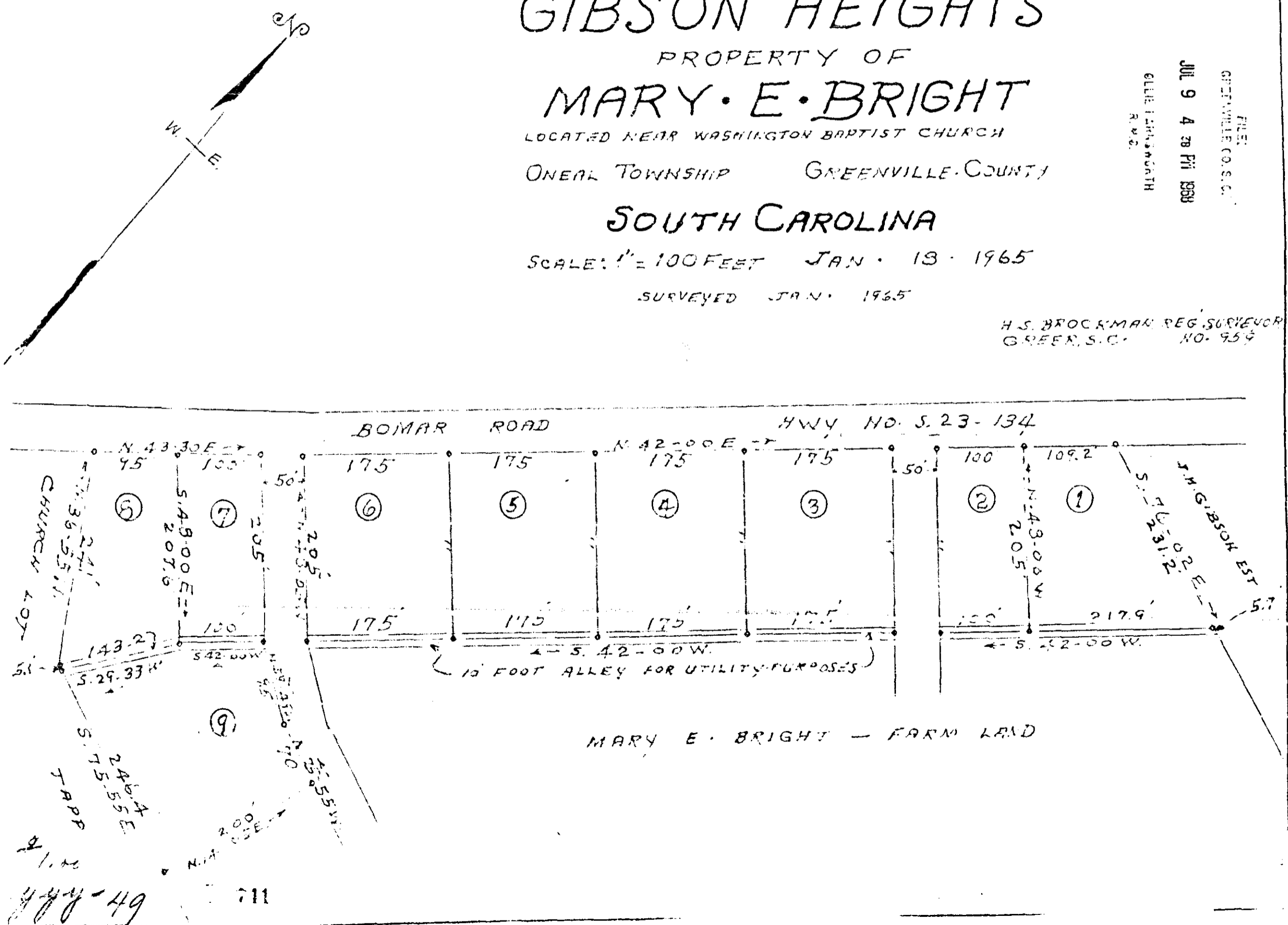

64-49
112